

# Transportation Demand Management Geographical Information Systems (GIS) Analysis

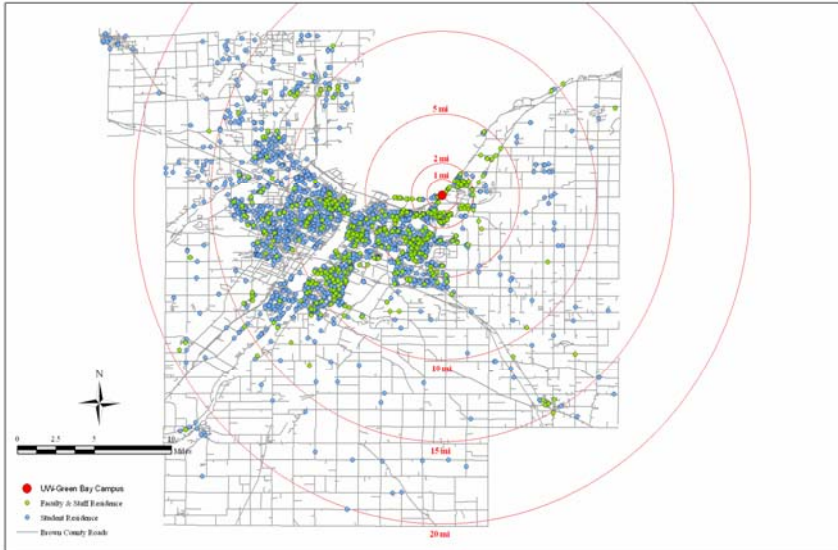

**Map 1. Faculty, Staff, and Student Residences Located in Brown County**

Addresses on file with UW-Green Bay for faculty, staff and students that live in Brown County were geocoded using ArcGIS 9. U.S. Census TIGER centerline data for Brown County was used as reference layer.

From this analysis it was determined that 482 faculty and staff and 2,091 students have a permanent address located in Brown County.

**Map 2. Faculty, Staff, and Student Residences Located Within 0.5 Miles of any Green Bay Metro Bus Route**

Incorporating a map of the Green Bay Metro Bus Routes into the Brown County analysis allowed for the approximate number of individuals located within a half mile of any bus route to be determined.

From this we found that approximately 332 faculty and staff and 1,355 students fall into that category.

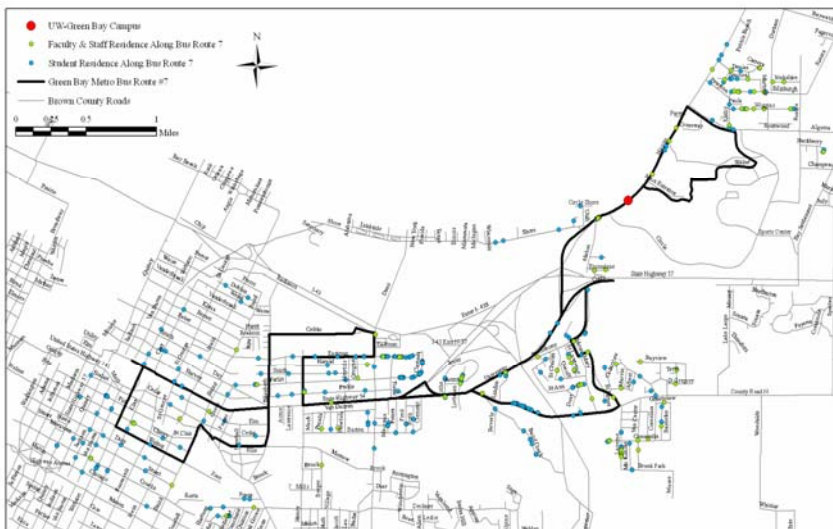
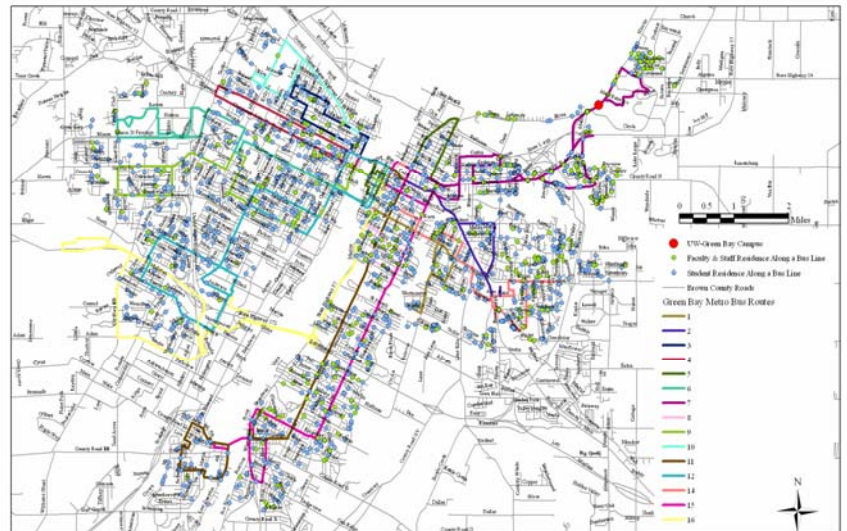

**Map 3. Faculty, Staff, and Student Residences Located Within 0.5 Miles of Green Bay Metro Bus Route #7**

The #7 bus route includes UW-Green Bay and is the only bus an individual can take that will go directly to campus without requiring a transfer at the downtown station. It was determined that approximately 93 faculty and staff and 367 student residences are located within one half mile of this bus route.