



GLOBUS®
Every journey tells a storySM

COSMOS®
Turning travel dreams into realitySM

MoNoGRAMS®
INDEPENDENT TRAVEL. SIMPLIFIED.™



.....

DANUBE DREAMS w/PRAGUE

11 Day River Cruise from Prague to
Budapest

.....

WDBQ

OCTOBER 12- 22, 2020

UNIVERSITY OF WISCONSIN GREEN BAY



SHIP INFORMATION

VIEW



 **AVALON**
WATERWAYS®

AVALON VIEW

BUILT 2020

LENGTH 443 FT

CREW MEMBERS 47

STATEROOMS 16

SUITES 67

- Wall-to-Wall Panoramic Windows
- Sky Deck with premium lounge chairs, whirlpool, shade awnings, & outdoor deck game area
- State-of-the-art fitness center
- Non-smoking staterooms & ship interior
- Convenient Elevator Service
- Elegant, contemporary design
- Outside viewing deck
- Headsets for guided shore excursions in Europe
- English-speaking friendly crew, staff & professional Cruise Director
- Sightseeing with Expert Local Guides
- Onboard lectures, activities & entertainment
- Room service for Continental breakfast & beverages (service fee applies)
- Sky Deck whirlpool
- Complimentary computer use in public areas
- Complimentary Wi-Fi access
- Onboard Adventure Center with active gear, bikes, Nordic walking sticks, watercraft & maps
- Light lunch & casual dinner in the Panorama Bistro



ADDITIONAL AMENITIES



- Behind-the-scenes galley tour
- Choice of Leisurely, Traditional or Independent sightseeing pace options
- Nordic walking sticks available onboard for complimentary check-out
- Onshore & Onboard experiences with regional customs, cultures & tastings with local artisans, experts & entertainers
- Flatscreen satellite TV with English-speaking channels & over 100 free movie options
- Onboard assistance is available to recommend, reserve and further personalize your cruise
- Linger over several selections from the Panorama Bistro's tasting menu for a less formal "sit-down" atmosphere
- Sky Deck game area
- Self-serve beverage station with complimentary tea, hot chocolate & premium coffees, including decaf options
- Well-stocked library with books, cards, and board games
- Complimentary bottled water, fresh fruit, and cookies available throughout the day
- Full-size closet mirror



DECK PLAN & ROOM CONFIGURATIONS



SKY DECK



ROYAL DECK

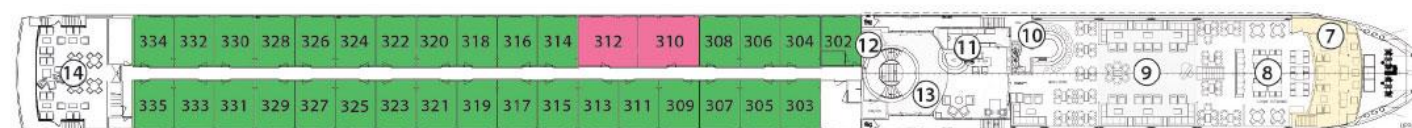

SAPPHIRE DECK

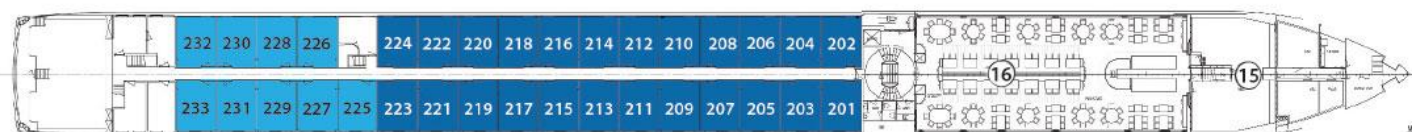

INDIGO DECK

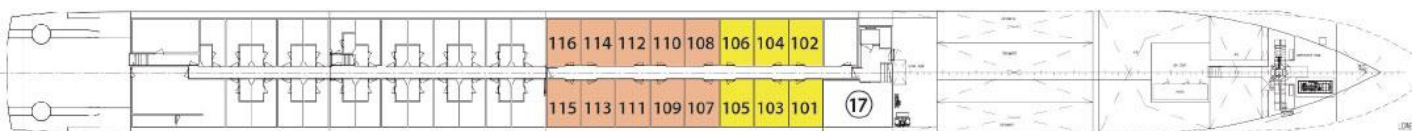

DECK PLAN

- | | | |
|---|----------------------|-------------------|
| 1 Sky Lounge | 6 Deck Game Area | 12 Elevator |
| 2 Navigation Bridge | 7 Observation Lounge | 13 Lobby |
| 3 Sky Grill | 8 Panorama Bistro | 14 Club Lounge |
| 4 Whirlpool | 9 Panorama Lounge | 15 Galley |
| 5 Premium Lounge
Chairs and Shade
Awnings | 10 Bar | 16 Dining Room |
| | 11 Reception | 17 Fitness Center |

CATEGORIES

- | | |
|--------------------|---|
| Royal Suite | Royal Deck Royal Suites |
| Cat. P | Royal Deck Panorama Suites |
| Cat. A | Sapphire Deck Forward Panorama Suites |
| Cat. B | Sapphire Deck Aft Panorama Suites |
| Cat. D | Indigo Deck Aft Deluxe Staterooms |
| Cat. E | Indigo Deck Forward Deluxe Staterooms |

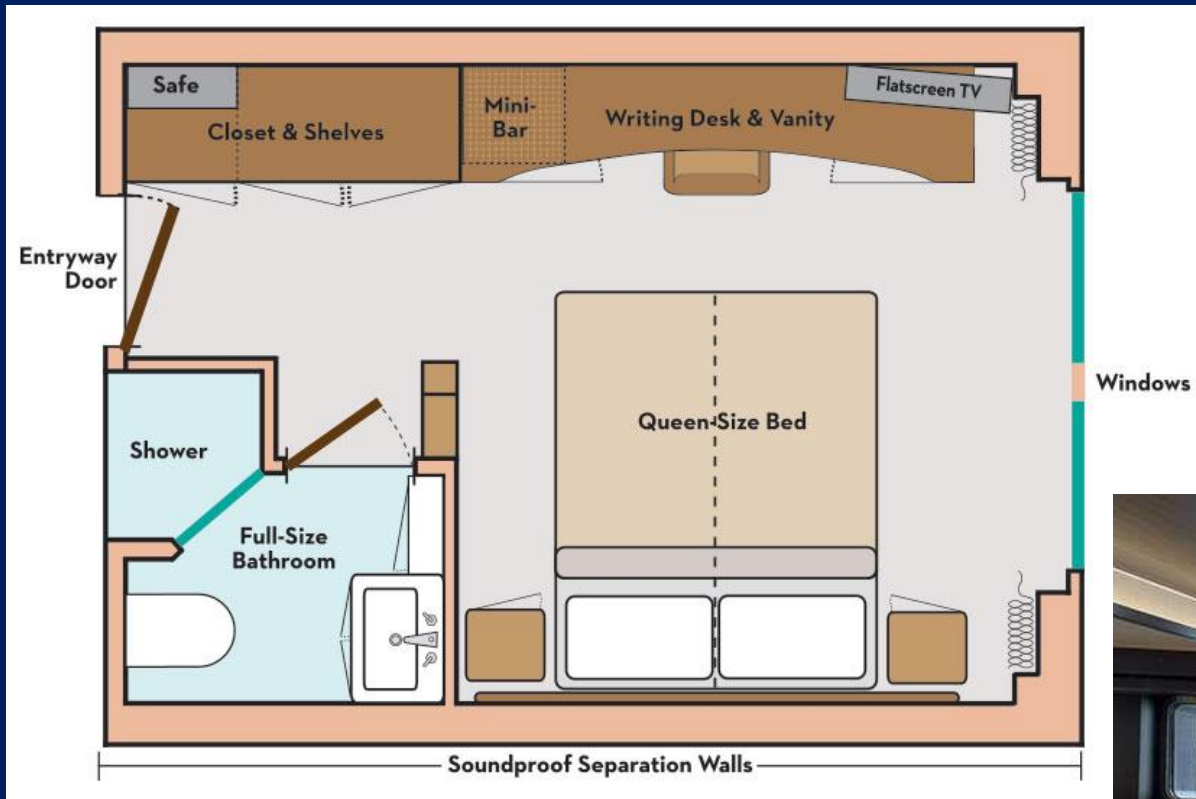

Staterooms & Suites

Avalon Deluxe Stateroom (Cat E, D) – 172 sq. ft.



AVALON DELUXE STATEROOM FEATURES (E & D)

- Comfort Collection BedsSM
- Egyptian super-combed cotton linens
- Soft & firm pillows
- Choice of bed configuration
- Bedside tables with reading lamps
- L'Occitane bath products
- Easy under-bed luggage storage
- Alarm clock
- Bathrobes & slippers
- Complimentary bottled water
- Individual climate control
- Large mirror in bathroom
- Luxurious mattress toppers
- European-style duvets
- Extra blankets
- Nightly turn-down service
- Hairdryer
- Spacious 3-door closets with shelves for ample storage
- Flatscreen satellite TV with English-speaking channels & over 100 free movie options
- Direct-dial telephone
- Well-stocked minibar
- In-room safe
- Elegant, contemporary design
- USB Ports
- Full shower with glass door
- Vanity and lighted makeup mirror
- Complimentary Wi-Fi
- Two windows
- Writing desk and chair



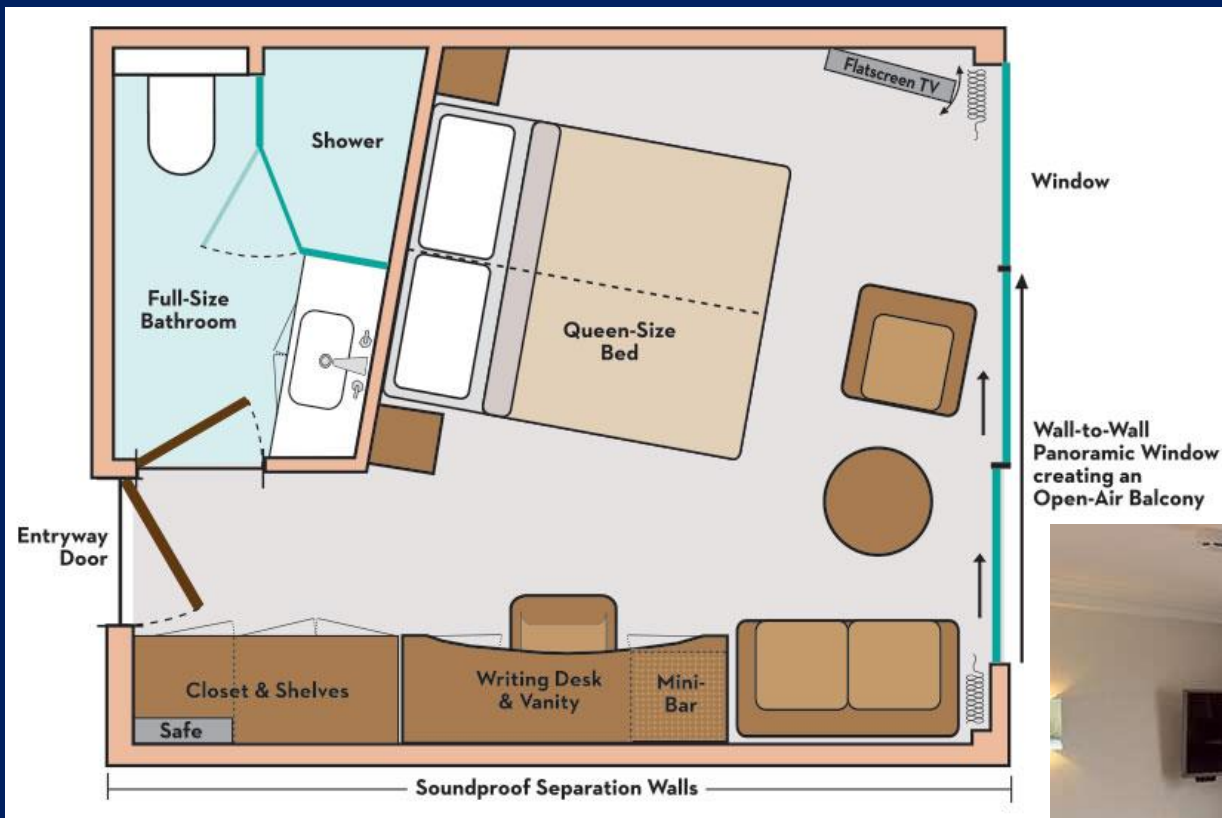

Staterooms & Suites

Panorama Suite (Cat A, B, P) – 200 sq. ft.



PANORAMA SUITE FEATURES (B, A & P)

- Comfort Collection BedsSM
- Egyptian super-combed cotton linens
- Soft & firm pillows
- Choice of bed configuration
- Bedside tables with reading lamps
- L'Occitane bath products
- Easy under-bed luggage storage
- Alarm clock
- Direct-dial telephone
- Well-stocked minibar
- In-room safe
- Elegant, contemporary design
- Marble countertops in bathroom
- Luxurious mattress toppers
- European-style duvets
- Extra blankets
- Nightly turn-down service
- Hairdryer
- Spacious 3-door closets with shelves for ample storage
- Flatscreen satellite TV with English-speaking channels & over 100 free movie options
- Make-up mirror
- Bathrobes & slippers
- Complimentary bottled water
- Individual climate control
- Large mirror in bathroom
- USB Ports
- 6-person sitting area
- Writing desk and chair
- Sofa
- Complimentary Wi-Fi
- Wall-to-Wall Panoramic Window with Open-Air BalconySM
- Full shower with glass door
- Vanity and lighted makeup mirror
- Coffee table



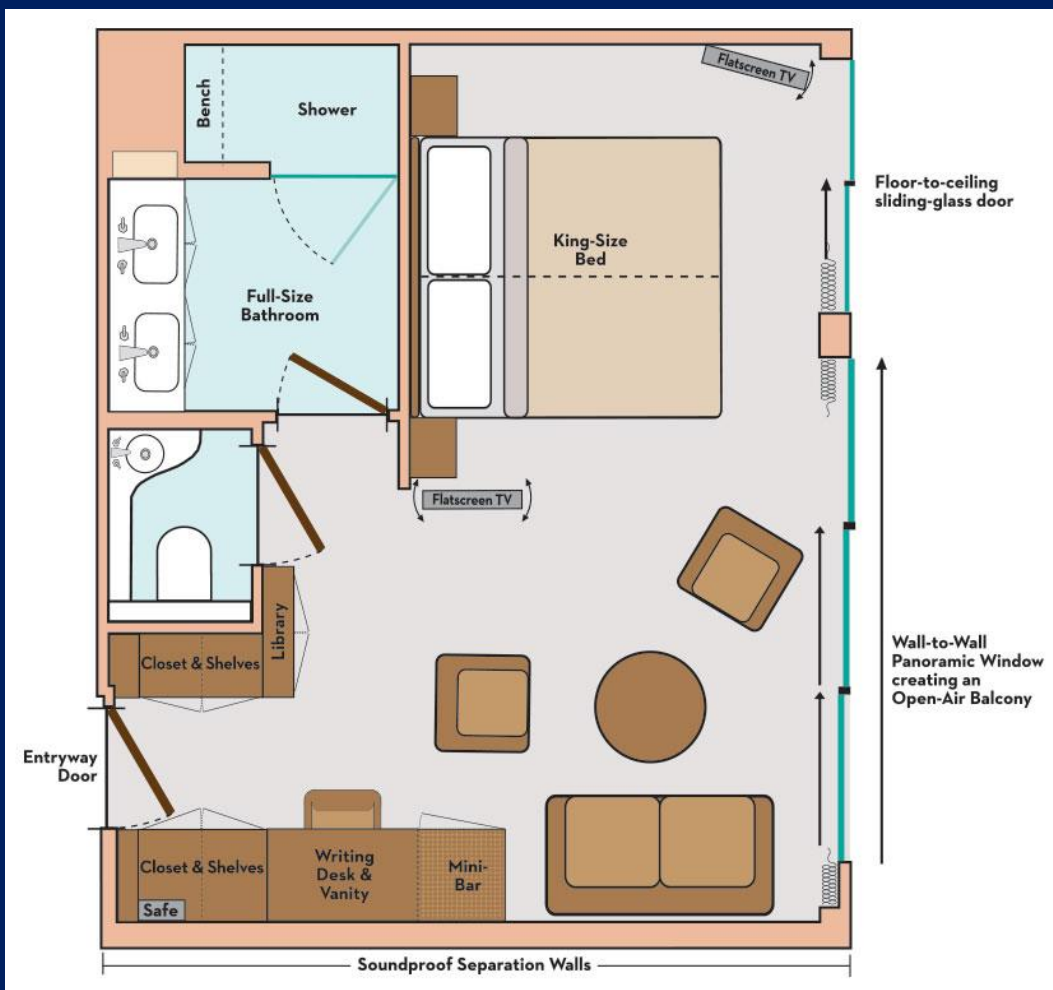

Staterooms & Suites

Royal Suite – 300 sq. ft.



ROYAL SUITE FEATURES

- Comfort Collection BedsSM
- Egyptian super-combed cotton linens
- Soft & firm pillows
- Choice of bed configuration
- Bedside tables with reading lamps
- L'Occitane bath products
- Easy under-bed luggage storage
- Alarm clock
- Direct-dial telephone
- Well-stocked minibar
- In-room safe
- Elegant, contemporary design
- Marble countertops in bathroom
- Luxurious mattress toppers
- European-style duvets
- Extra blankets
- Nightly turn-down service
- Hairdryer
- Spacious 3-door closets with shelves for ample storage
- Flatscreen satellite TV with English-speaking channels & over 100 free movie options
- Make-up mirror
- Bathrobes & slippers
- Complimentary bottled water
- Individual climate control
- Large mirror in bathroom
- USB Ports
- 6-person sitting area
- Writing desk and chair
- Sofa
- Double sinks
- Complimentary Wi-Fi
- Wall-to-Wall Panoramic Window with Open-Air BalconySM
- Full shower with glass door
- Vanity and lighted makeup mirror
- Coffee table



BOARD YOUR OVERNIGHT FLIGHT
YOUR VACATION BEGINS THE NEXT DAY





DAY 1: PRAGUE, CZECH REPUBLIC

 **AVALON**
WATERWAYS®



DAY 2: PRAGUE

 **AVALON**
WATERWAYS®



DAY 2: PRAGUE





Astronomical Clock

GLOBUS[®]
family of brands



Charles Bridge

St. Vitus Cathedral



HRADČANY CASTLE GROUNDS



DAY 3: PRAGUE





MUSEUM OF COMMUNISM

GLOBUS
family of brands





DAY 3: DEGGENDORF, GERMANY (EMBARKATION)

 **AVALON**
WATERWAYS®



DAY 4: PASSAU—SCHLÖGEN OXBOW

 **VALON**
WATERWAYS®

St. Stephen's Cathedral



PASSAU



Classic: Guided City Walk



Active: Hiking from Oberhaus



Free Time: Explore Passau on your own (St. Stephen's Cathedral pictured)



SCHLÖGEN OXBOW





DAY 5: LINZ, AUSTRIA

 **VALON**
WATERWAYS®

LINZ



Classic Guided Walking Tour



OPTIONAL EXCURSION TO:

SALZBURG

OR

CESKY KRUMLOV





DAY 6: MELK–WACHAU VALLEY

 **VALON**
WATERWAYS®

MELK'S MAGNIFICENT BENEDICTINE ABBEY



Classic Guided Walking Tour



Benedictine Abbey





SAIL THROUGH THE WACHAU VALLEY PAST VINEYARDS, CASTLES, AND
CHARMING VILLAGES ON YOUR WAY TO DÜRNSTEIN



Wachau Valley





DÜRNSTEIN



Stiftskirche



DÜRNSTEIN



Classic: Guided Walk



Active: Guided Hike up to the ruins



Discovery: Wine Tasting on board



DAY 7: VIENNA

 **VALON**
WATERWAYS®

VIENNA (OVERNIGHT)



VIENNA



Discovery Guided Walking Tour



VIENNA



ART HISTORY MUSEUM



Classic Local Viennese Museum Visit

Hofburg Imperial Palace



VIENNA OPERA HOUSE



St. Stephen's Cathedral



OPTIONAL EXCURSION TO SCHONBRUNN PALACE



FREE TIME IN VIENNA

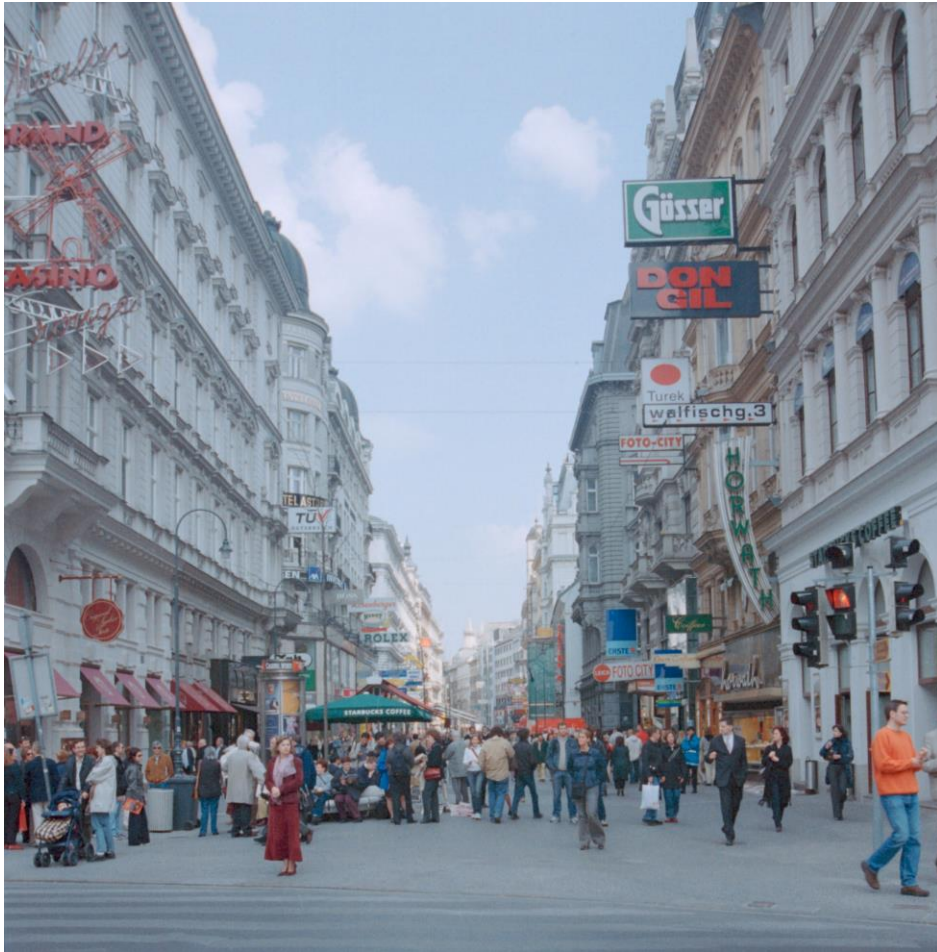

Kärntnerstrasse



Explore the streets and squares of Vienna
by bike



DAY 8: BRATISLAVA, SLOVAKIA

 **VALON**
WATERWAYS®



CLASSIC: TAKE A GUIDED CITY WALK



HIKE TO BRATISLAVA CASTLE ON YOUR OWN





DAY 9: BUDAPEST, HUNGARY

 **VALON**
WATERWAYS®

BUDAPEST

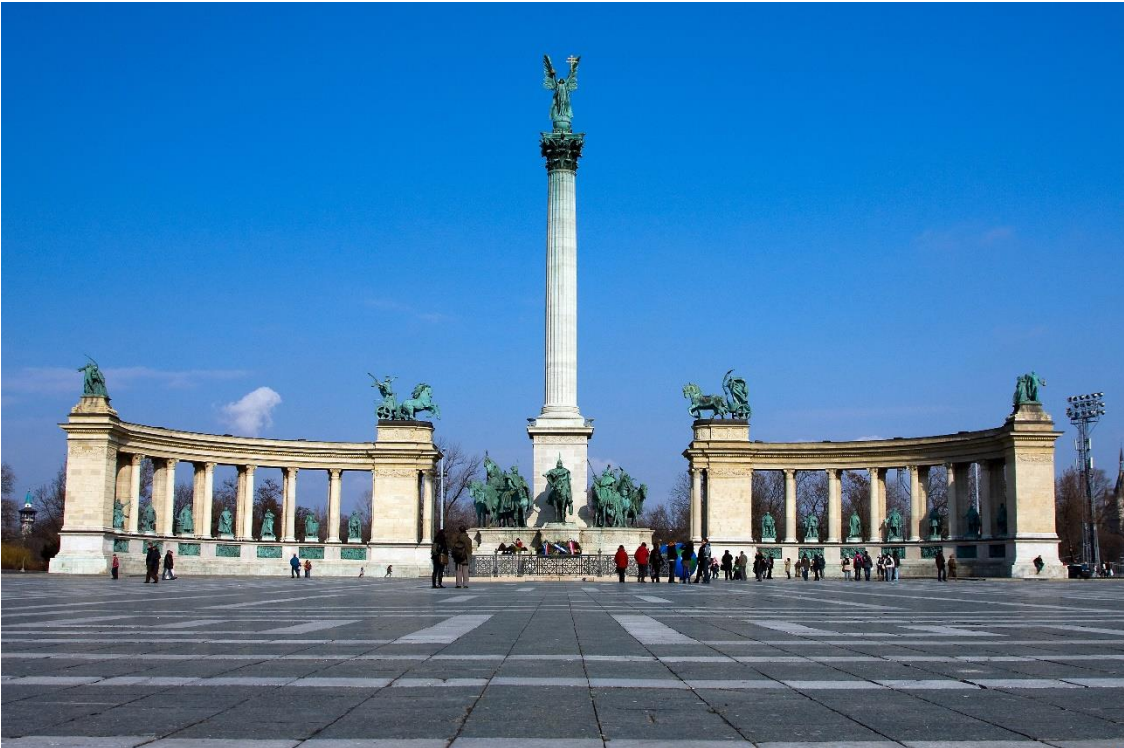

Classic Guided Sightseeing

Hero's Square







The Fisherman's Bastion



11th-century Matthias Church



Chain Bridge



Elizabeth Bridge

Stephen's Basilica





DAY 10: BUDAPEST (DISEMBARKATION)
YOUR CRUISE ENDS WITH BREAKFAST THIS MORNING.



MEALS

- FlexDiningSM for more venue and seating options, including flexible seating times in our main Dining Room
- Avalon FreshSM healthy cuisine options at every meal
- Complimentary sparkling wine with breakfast; wine, beer, or soft drinks with every lunch and dinner
- Early and Late Riser breakfast options
- Daily full buffet breakfast with made-to-order egg station, hot and cold menu items
- Daily lunch buffet with pasta or carving stations
- Alternative light lunch or Sky Grill on the Sky Deck (weather permitting)
- Daily Afternoon Tea featuring tea, coffee, sweet treats & sandwiches
- Daily four-course a la carte dinner in the main Dining Room with choice of appetizers, soups, salads, entrees and desserts. Includes selections of regional recipes, Western dishes and vegetarian options.
- Alternative Panorama Bistro dinner, featuring regional specialties and small plates
- Captain's welcome & farewell receptions and dinners with sparkling wine and canapés
- Panorama Lounge featuring premium spirits and Avalon specialty cocktails, along with local entertainment special guests
- Cocktails available on the Sky Deck
- Fresh fruit available throughout the day

PRICING

October 12-22, 2020

- **Cat E \$3,925.00**

Includes:

Land/cruise, port charges, tips/gratuities, travel protection, arrival & departure transfers

- **Per Passenger Accommodation Pricing Options**

	Twin	Single	Single Land	
GROUP GPA CAT A View	\$1,199.00	\$3,756.00 + \$270.00		
GROUP GPB CAT B View	\$1,149.00	\$3,678.00 + \$270.00		
GROUP GPD CAT D View	\$199.00	\$2,206.00 + \$270.00		
GROUP GPE CAT E View		\$1,897.00 + \$270.00		
GROUP GPP CAT P View	\$1,299.00	\$3,911.00 + \$270.00		
GROUP GPP CAT P View	\$2,199.00			

DEPOSITS AND KEY DATES

- Deposit of \$250 per person
- Final payment due July 10, 2020

PAYMENT OPTIONS

➤ Check payment:

Please make checks payable to: **Avalon Waterways**

Mail to: Globus family of brands
Attn: Direct Groups Anna Elkind
5301 S. Federal Circle,
Littleton, CO 80123

➤ Paying online via link: <https://groups.globusfamily.com/payments/>

Add in comments:

Reservation: University of Wisconsin Green Bay

Add in Reservation # box: 1-771759329

➤ Paying by phone: **1-866-821-2752**

Room & Deck Selection

View deck plans, layouts and categories to help with selecting your room.

Royal Suite - 300 sq. ft.



Panorama Suite (Cat. A, B, P) - 200 sq. ft.



Avalon Deluxe Stateroom (Cat. E, D) - 172 sq. ft.



Number of rooms to select: 1

Make your selection below. Please note, there may be price differences for certain staterooms and decks.



Suite
Royal Deck (+\$2,199.00 p/p upgrade)

Cat. P
Royal Deck (+\$1,299.00 p/p upgrade)

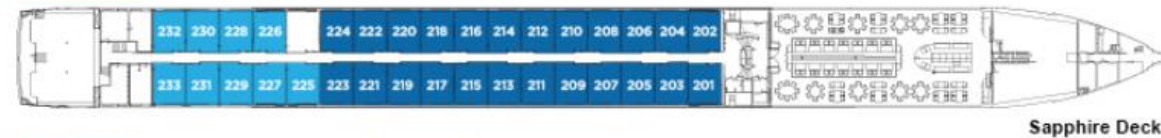

Cat. A
Sapphire Deck Forward (+\$1,199.00 p/p upgrade)

Cat. B
Sapphire Deck Aft (+\$1,149.00 p/p upgrade)

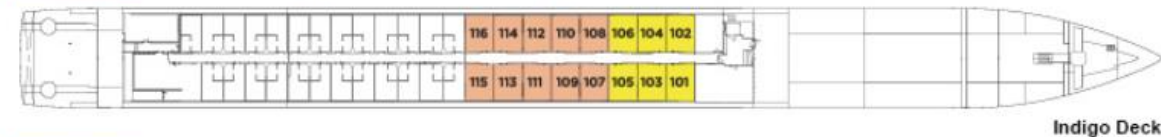

Cat. D
Indigo Deck Aft (+\$199.00 p/p upgrade)

Cat. E
Indigo Deck Forward

CURRENT AVAILABILITY



TRAVEL PROTECTION

Trip Cancellation & Interruption
Protection *up to **the cost of the trip***

***Delayed Arrival & Missed
Connection Coverage up to \$1,000***

Upgrade Protection up to \$1,000

Trip Delay Protection up to \$1,000

Travel Protection Plus *

Due with Deposit

***To waive pre-existing
conditions***

Baggage & Travel Documents up to \$2,500

Baggage Delay up to \$250

Sickness Medical Expense up to \$25,000

Accident Medical Expense up to \$25,000

Dental Expense up to \$1,000

***Emergency Medical Transportation up to
\$50,000***

***Accidental Death & Dismemberment up to
\$25,000***

Repatriation up to \$15,000

Flight Accident up to \$100,000

Waiver of Pre-existing Medical Conditions*

IMPORTANT INFORMATION

PLEASE NOTE

- On trip and emergency contact information is due per person by Final Payment
- Passenger documents are sent 2–3 weeks prior to departure. Travel documents will not be sent until on trip and emergency contacts are provided for each passenger. Please contact your group leader with your emergency contact information.
- On trip contact cannot be your group leader



iOS and Android traveler apps

Connected with the customer's vacation/itinerary

**Flights, eDocuments and Pre/Post nights
Notifications and Alerts**

**Travel Guides, Maps, Recommendations (Dining, Sights,
Shopping, Entertainment)**

Travel Journal and Expense Calculator

Currency Converter and Weather Forecast

Social media sharing

Augmented reality navigation



**CARING FOR
THE PLACES
WE'RE
SHARING
WITH YOU**

WHY SWITCH FROM PAPER TRAVEL DOCUMENTS TO ELECTRONIC TRAVEL DOCUMENTS (E-DOCS)?

For every guest who chooses E-docs INSTEAD of paper docs, the Globus family of brands will make a donation toward the unprecedented efforts of The Ocean Cleanup, an organization working to reduce that massive floating plastic island in the Pacific Ocean, AND ridding the world's oceans of plastics overall!

Choosing E-docs instead of paper docs = reduces landfill waste AND provides \$\$\$ for The Ocean Cleanup meaning cleaner & healthier oceans = happier and abundant animals = happier & healthier Earth = happier & healthier people for generations to come!

Let's come together and choose electronic travel documents over paper – it's the first step we can make in helping the planet we share with so many.



GLOBUS.

COSMOS.

GLOBUS.
family of brands

MONOGRAMS

AVALON
WATERWAYS



DANUBE DREAMS

11 DAY RIVER CRUISE PRAGUE TO BUDAPEST



 **AVALON**
WATERWAYS®

